



THE KNOLL GARDEN AT THE KU-RING-GAI WILDFLOWER GARDEN, 420 MONA VALE RD, ST IVES

What kind of garden is it?

The objective of the Knoll Garden is to showcase a range of Australian native plants, (groundcovers, shrubs and trees) of the Sydney District that can be grown in a garden situation. Native plants that are attractive, easy to establish and maintain and will attract birds and butterflies.

Where is it?

The Knoll Garden is located at Lamberts Clearing picnic area, adjacent to the Fern House. The Knoll Garden, within the fenced area, utilises the rock rises to add landscape appeal to the plant display. The Knoll rises up about 30m and is capped by a flat area dominated by a tall, mature Eucalypt tree.

Getting around the Garden

The Garden is about 1000 m² in area and is generally accessed by a gate fronting Lamberts Clearing. The layout and paths are shown in the **map** overleaf. A wide, stepped walkway to the left of the rock shelf leads up beside beds and onto The Knoll. Steps also lead down alongside the lower beds adjacent to the Fern House.

The Plants

There are some 500 individual plants of about 150 different species. Many are established plants but the great diversity is being achieved by plantings of juvenile plants which will mature over time.

Some beds have been planted with predominately one plant group – see **map** –

1. Prostanthera (Mint Bush)
2. Grevillea (Spider Flower)
3. Rutaceae (Boronia, Crowea, Phebalium)
4. Ferns and orchids
5. Water-wise plants (Lomandra, Dianella)

The majority of the plants have labels and labelling will be improved over time. The flowering time for the majority of plants is late winter/spring, however there will be plants flowering at other periods of the year.

If you think a plant is great for your garden, note the name and obtain from a local nursery, particularly one specialising in Australian native plants. Inexpensive tube stock is useful if a large area is to be planted.

Information on Australian plants, plant lists and nurseries and the range of activities of the North Shore Group of the Australian Plants Society (APS) can be accessed at blandfordia.org.au and linked sites. Walks & Talks are held at KWG on Mondays. Visitors to our activities are most welcome.

The Knoll Walk

The top of The Knoll can be accessed by a short, easy walk – pass through the top gate and continue up the steps bearing right at the top of them. In spring there is a good display of Wedding Bush, Pink Eriostemon and Paper Daisy. A short distance along turn off to the large Eucalypt (gum) tree where there is a lookout over The Knoll Garden and Lamberts Clearing. Back on the main track, continue bearing right and down steps and back into The Knoll Garden via the side gate.

History

Previously a market garden and chicken farm, The Knoll's rocky outcrop attracts attention from the flat grassed area below.

The North Shore Group of Australian Plants Society has a long association with The Knoll, since the inception of the Wildflower Garden in 1962. By 1965 APS interest was focussed on The Knoll area and Council staff cleared up The Knoll revealing 'some beautiful stone features'. At the same time the Fern House was started.

'Thus began the continuing saga of a feature of the Wildflower Garden which year after year has been cultivated, planted and re-planted to enthral visitors each spring with its massed display'.

A small band of enthusiastic members continued the good work but age did weary them and since 2000 the state of The Knoll deteriorated badly. In 2007 the Group resolved to return the area to its former glory. After clearing the infestation of bracken, the planting efforts of Group members and Garden staff were frustrated by the predation by wallabies and rabbits. Finally in 2011 the area was fenced, funded jointly by Council and the North Shore Group and the restoration of The Knoll Garden became a reality!



**NATIVE PLANTS
make
AUSTRALIAN GARDENS**



Australian Plants Society
North Shore Group

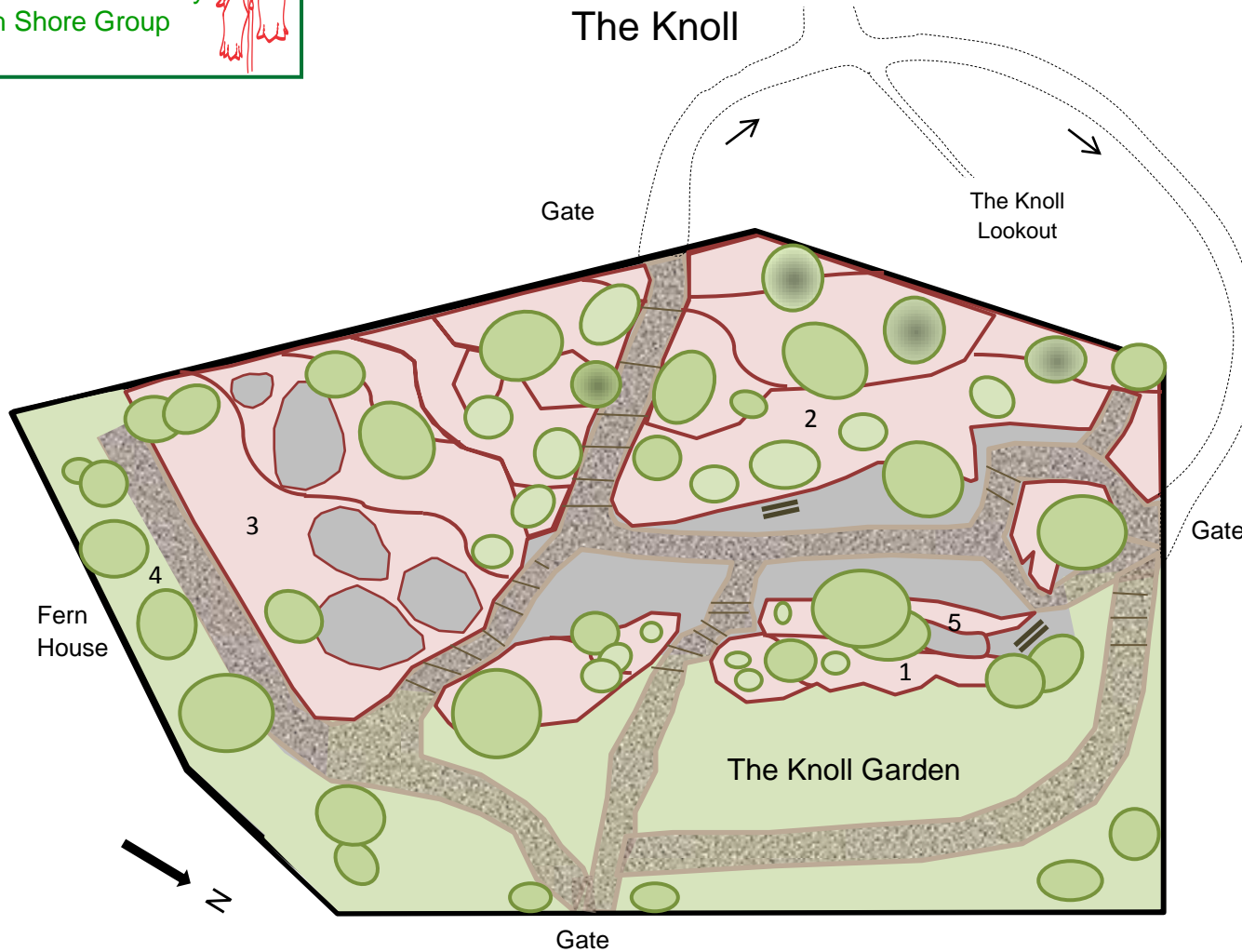

Key	
	Paths
	Steps
	Beds
	Rock area
	Trees/Shrubs
	Seats

Plant symbols	
	Butterfly attracting
	Bird attracting
	Scented foliage
	Part shade
	Low water needs

Lamberts Clearing